



SERVIÇO PÚBLICO FEDERAL
CONSELHO FEDERAL DE MEDICINA VETERINÁRIA

ANEXO I – PROJETO BÁSICO

ANEXO I – DOCUMENTAÇÃO BÁSICA

ACESSÍVEL EM: drive.google.com/drive/folders/12ZLNuNnHmyz1TiYp0gp71s6uuglaQe8r

ANEXO 03 – PROJETOS

ESTRUTURA

ESTRUTURA PRÉDIO ANTIGO



CFMV
CONSELHO FEDERAL DE MEDICINA VETERINÁRIA
SISTEMA CFMV/CRMVs

SIA - TRECHO 3, LOTES 145/155 - CEP: 71200-037 - BRASÍLIA-DF
TELEFONE: +55 (61) 2106-0400
CFMV@CFMV.GOV.BR - WWW.CFMV.GOV.BR

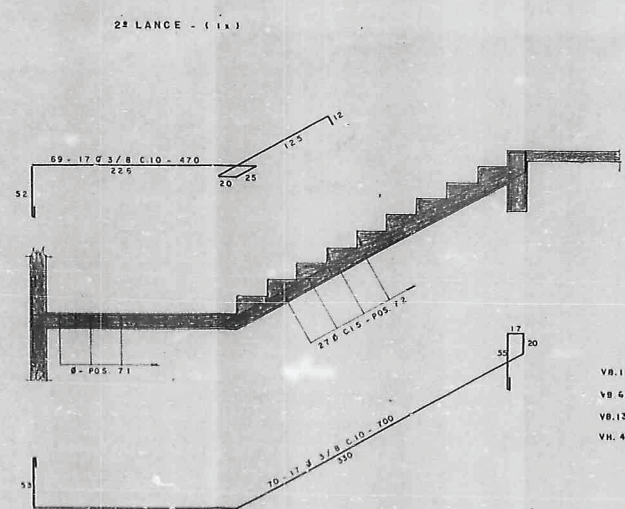
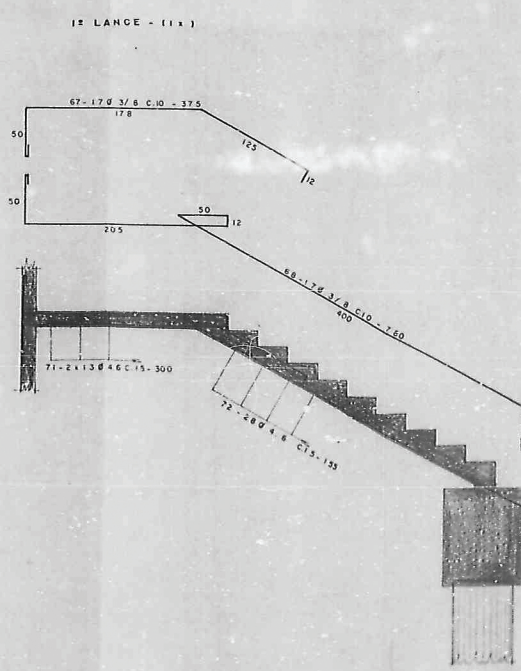
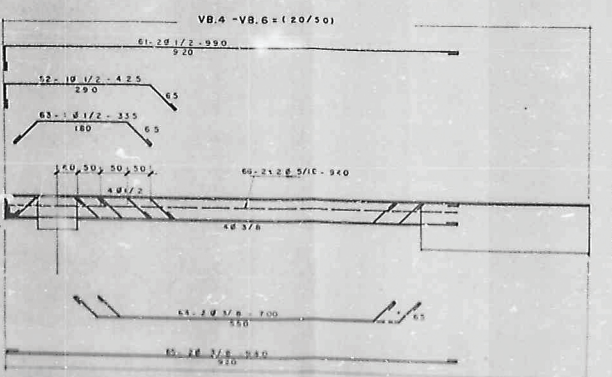
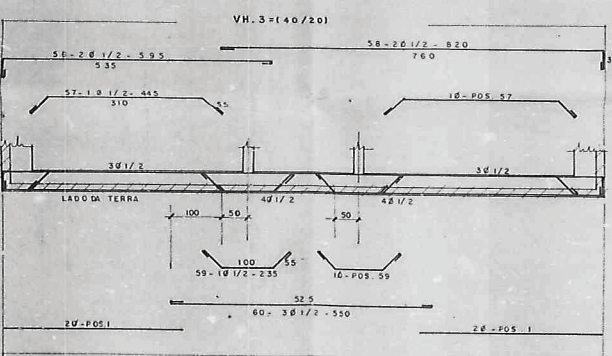
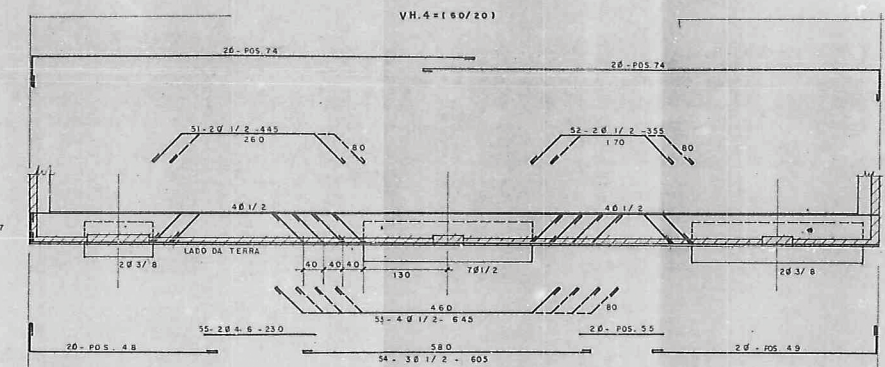
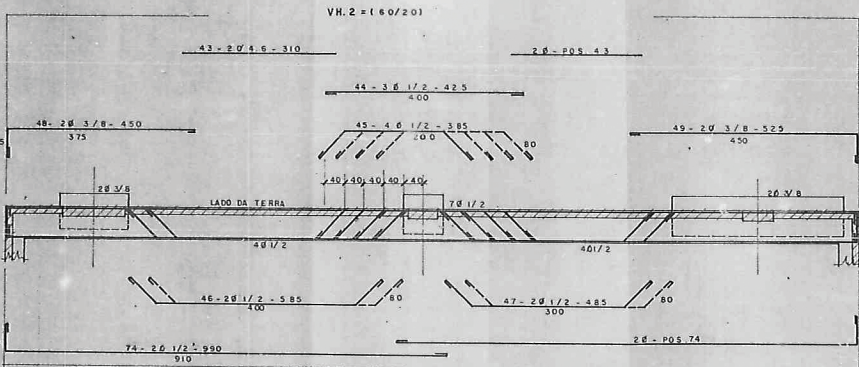
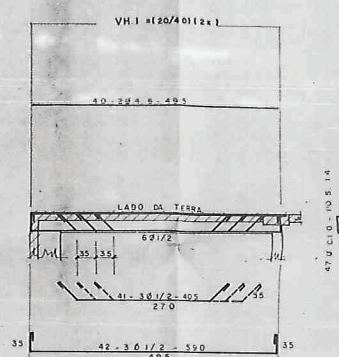
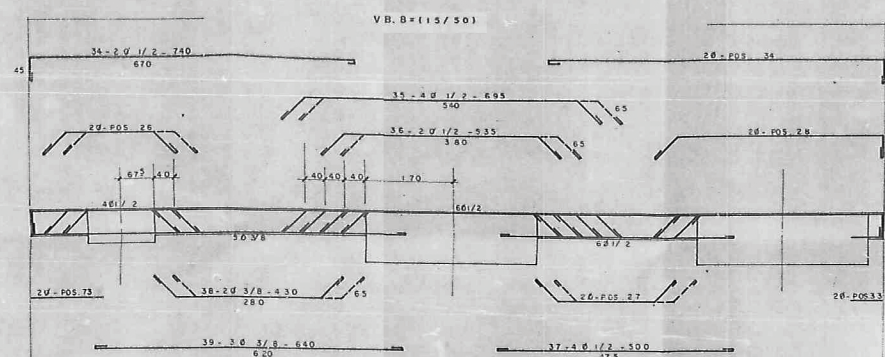
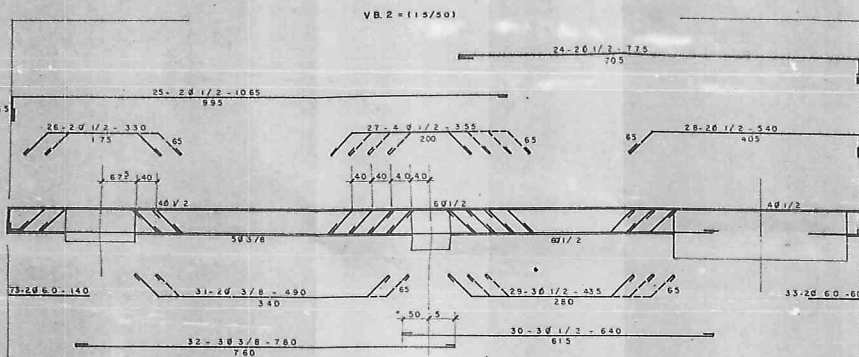
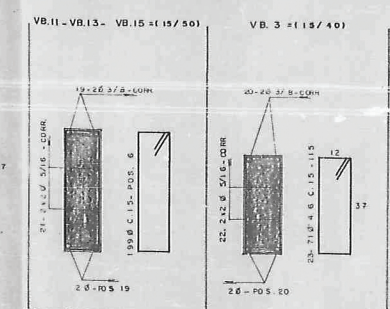
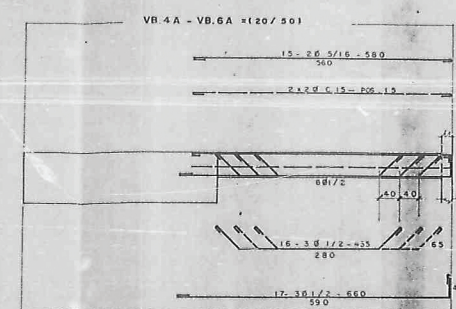
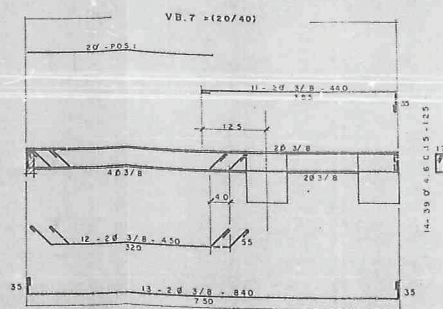
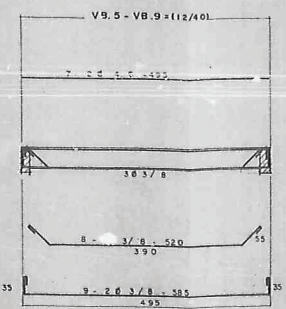
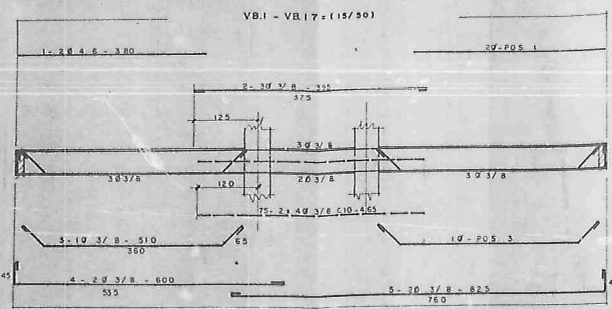

POS.	Ø	Q.	COMR.
1	4.6	13	3.80
2	3/8	6	3.95
3	"	4	5.10
4	"	4	6.00
5	"	4	8.25
6	4.6	4.84	1.35
7	"	4	4.95
8	3/8	2	5.20
9	"	4	5.85
10	4.6	62	1.10
11	3/8	2	4.40
12	"	2	4.50
13	"	2	8.40
14	4.6	1.33	1.25
15	5/8	12	5.80
16	1/2	6	4.35
17	"	6	6.60
18	4.6	2.42	1.45
19	3/8	4	CORR
20	"	4	CORR
21	5/8	4	CORR
22	"	4	CORR
23	4.6	7.1	1.15
24	1/2	2	7.75
25	"	2	10.65
26	"	4	3.30
27	"	6	3.55
28	"	4	5.40
29	"	3	4.35
30	"	3	6.40
31	3/8	2	4.90
32	"	3	7.80
33	6.0	4	0.60
34	1/2	4	7.40
35	"	4	6.95
36	"	2	5.35
37	"	4	5.00
38	3/8	2	4.30
39	"	3	6.10
40	4.6	4	4.95
41	1/2	6	40.5
42	"	6	5.90
43	4.6	4	3.10
44	1/2	3	4.25
45	"	4	3.85
46	"	2	5.85
47	"	2	4.85
48	3/8	4	4.50
49	"	4	5.25
50	4.6	3.40	1.45
51	1/2	2	4.45
52	"	2	3.55
53	"	4	6.45
54	"	3	6.05
55	4.6	4	2.30
56	1/2	2	5.95
57	"	2	4.45
58	"	2	8.20
59	"	2	2.35
60	"	3	5.50
61	"	4	9.90
62	"	2	4.25
63	"	2	3.35
64	3/8	4	7.00
65	"	4	9.40
66	1/8	8	9.40
67	3/8	17	3.75
68	"	17	7.80
69	"	17	4.75
70	"	17	20.00
71	4.6	26	3.00
72	"	55	1.55
73	6.0	4	1.40
74	1/2	4	9.90
75	3/8	16	4.65

ASS	Ø	COMR.	PÊSO
6.0	8	2	
4.6	21.55	2.90	
5/8	3.01	1.45	
1/8	9.22	5.40	
1/2	2.620	2.610	
PÊSO TOTAL 35.87 Kg.			

RELAÇÃO
 VB.1 - VB.2 - VB.3 - VB.4 - VB.4A - VB.5 -
 VB.5 - VB.6A - VB.7 - VB.8 - VB.9 - VB.11 -
 VB.13 - VB.15 - VB.17 - VB.1 - VB.2 - VB.3 -
 VB.4

ENGEPRO - engenharia de projetos ltda
 R. S. ED. BARRAGAS, SALA 1008 - BRASÍLIA D.F.

CLIENTE	SOARES LEONE S.A.	PROJETO	ANIMAÇÃO VIGAS BALDRA E VIGAS HORIZONTAIS E ESCALA LANÇAS 1 e 2
BALANÇO	LUCILIO A. VITORINO	PROJETO	423
ARQUITETO	MANOEL BRANCO	PROJETO	
CONSTRUTORA	SOARES LEONE S.A.	PROJETO	
DATA	18/08/88	PROJETO	
DESENHADO	WILSON REIS	PROJETO	

C.E. 95/08

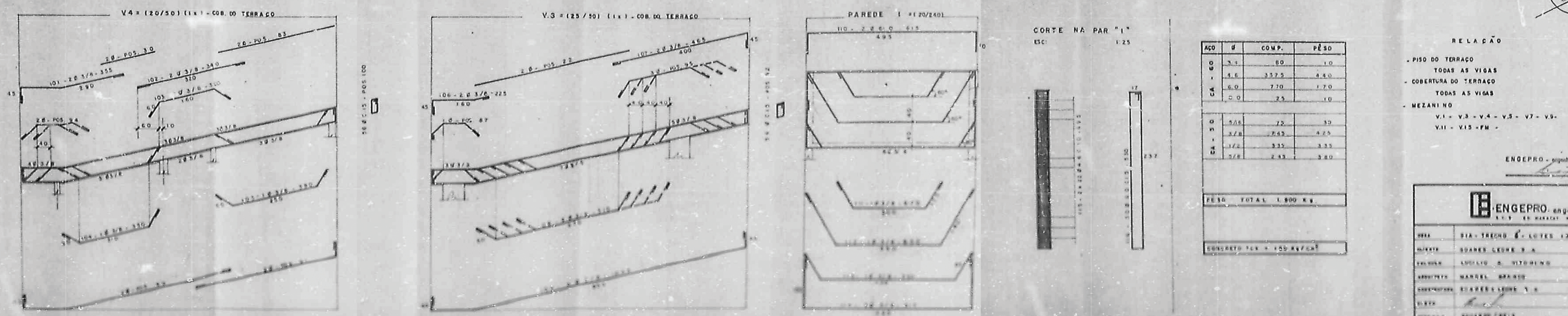
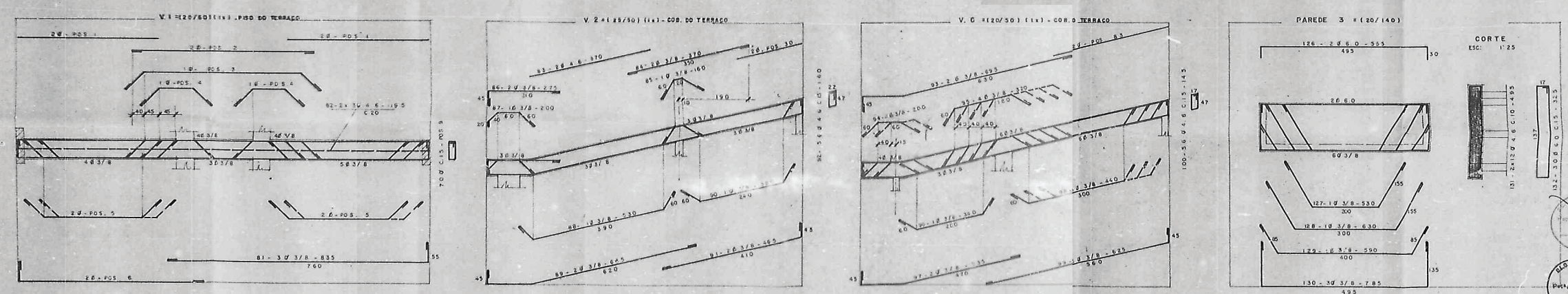
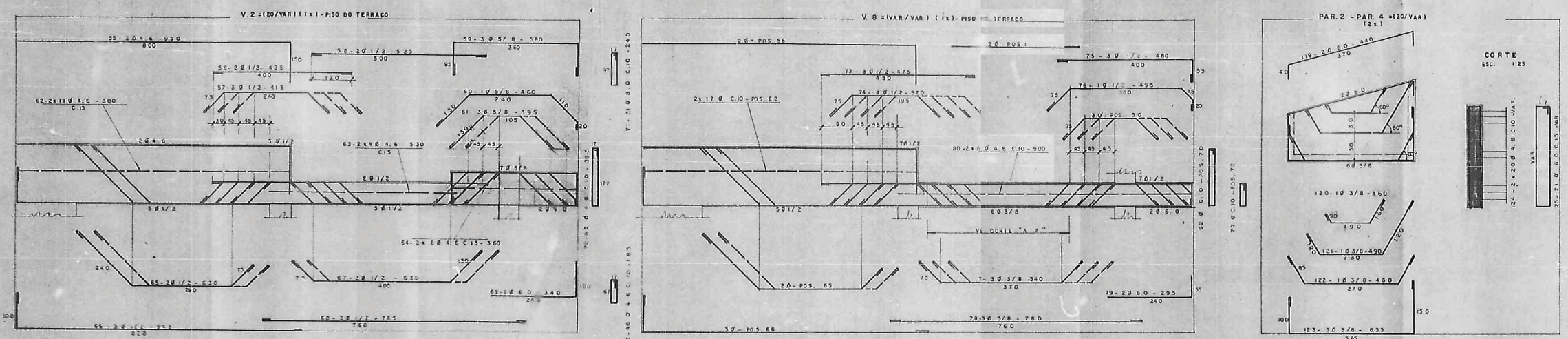
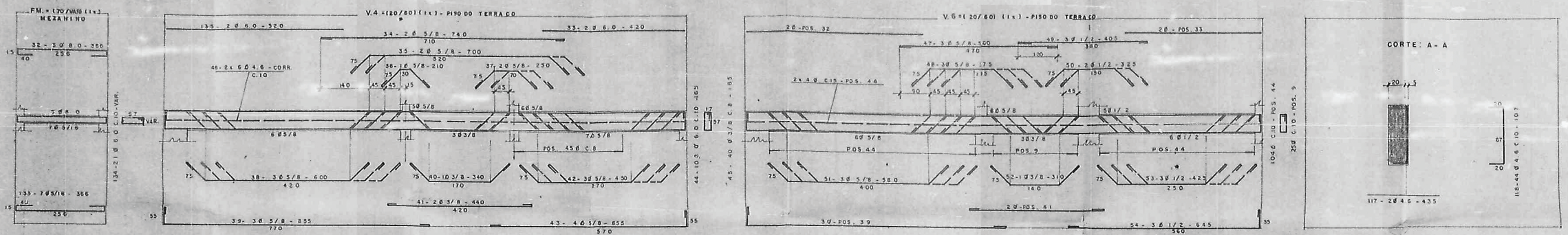
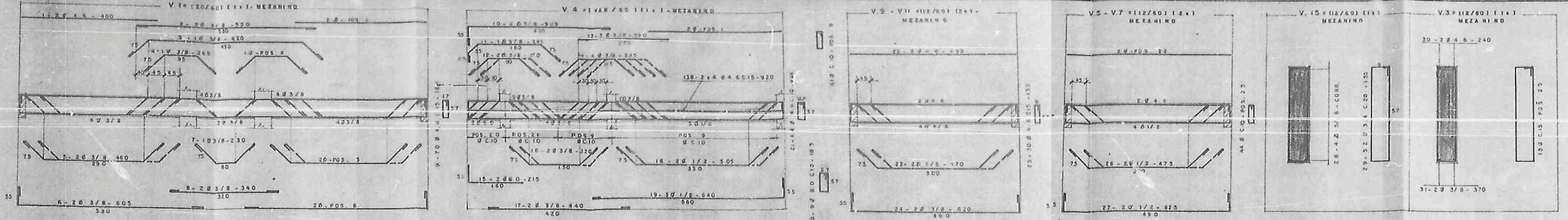

POS.	Ø	Q	COMP.
1	4.6	0	4.00
2	3.8	4	3.50
3	4	1	4.30
4	4	1	2.65
5	6	8	4.60
6	6	1	6.05
7	6	1	2.20
8	4.6	2.28	3.40
9	4.6	2.28	1.65
10	5.8	2	3.65
11	5.8	1	2.30
12	3.8	2	2.70
13	3.8	4	2.60
14	6	4	2.60
15	6	2	1.1
16	3.8	2	3.20
17	4.6	2	4.40
18	4.6	2	5.05
19	6	3	6.40
20	6	9	1.85
21	4.6	1.6	4.40
22	6	8	4.90
23	3.8	4	4.70
24	4	4	6.20
25	4.6	1.6	1.55
26	4.6	4	4.75
27	4	4	6.25
28	5.8	4	CORR
29	3.8	1.6	1.55
30	4.6	6	2.40
31	3.8	2	3.70
32	6	2	3.65
33	6	4	4.20
34	3.8	2	7.40
35	6	2	7.00
36	6	1	2.10
37	6	2	2.30
38	6	3	6.00
39	6	6	8.55
40	3.8	1	3.10
41	6	4	4.50
42	6	4	4.50
43	6	4	6.55
44	6	1.76	1.65
45	3.8	40	1.65
46	4.6	20	CORR
47	3.8	3	5.00
48	6	3	3.75
49	1/2	3	4.05
50	6	5	3.25
51	3.8	3	5.80
52	3.8	1	3.10
53	1/2	3	4.25
54	6	3	6.45
55	4.6	4	9.50
56	1/2	2	4.25
57	6	3	4.15
58	6	5	6.25
59	3.8	3	5.80
60	6	1	4.60
61	6	3	3.95
62	4.6	5.6	6.00
63	6	8	5.30
64	6	12	3.60
65	1/2	4	1.630
66	6	4	9.45
67	6	2	6.30
68	6	3	7.85
69	6	2	3.40
70	4.6	1.24	3.95
71	6	31	4.45
72	4.6	1.23	1.85
73	1/2	3	4.75
74	6	4	3.70
75	6	3	4.80
76	6	1	4.95
77	3.8	3	5.40
78	6	3	7.80
79	6	2	2.95
80	4.6	1	9.00
81	3.8	3	8.35
82	4.6	6	11.95
83	6	4	3.70
84	3.8	2	3.70
85	6	1	1.60
86	6	2	2.75
87	6	2	2.00
88	6	1	5.10
89	6	4	6.85
90	6	1	3.80
91	6	4	4.65
92	4.6	11.2	1.60
93	3.8	6	6.35
94	6	4	2.00
95	6	7	3.20
96	6	1	3.40
97	6	2	4.35
98	6	3	4.40
99	6	3	6.25
100	4.6	11.2	1.45
101	3.8	2	3.55
102	3.8	2	3.40
103	6	1	3.00
104	6	1	3.53
105	6	2	3.90
106	6	2	2.25
107	6	2	4.65
108	6	4	5.10
109	6	3	6.15
110	6	1	6.70
111	6	1	6.50
112	6	1	5.90
113	6	1	5.90
114	6	3	3.15
115	4.6	44	4.95
116	6	30	5.30
117	4.6	4	4.35
118	6	44	1.07
119	6	4	4.40
120	3.8	2	2.40
121	6	2	4.60
122	6	2	6.90
123	6	6	6.35
124	4.6	80	VAR
125	6	42	VAR
126	6	2	5.55
127	3.8	1	5.30
128	6	1	6.30
129	6	1	5.70
130	4.6	3	7.85
131	4.6	24	4.95
132	6	30	3.25
133	5.8	7	3.45
134	6	21	VAR
135	6	2	5.0
137	6	2	5.0

ACO	Ø	COMP.	PÉSO
Ø 3.8	60	1.0	
Ø 4.6	33.75	4.40	
Ø 6.0	7.70	1.70	
Ø 0.0	2.5	1.0	
Ø 5.8	7.2	3.0	
Ø 3.8	2.62	4.25	
Ø 1/2	3.33	3.33	
Ø 3.8	2.43	3.40	

PESO TOTAL 1.800 kg

CONCRETO T.C.A. = 100 kg/m³

RELAÇÃO

- PISO DO TERRAÇO

- TODAS AS VIGAS

- COBERTURA DO TERRAÇO

- TODAS AS VIGAS

- MEZANINO

V.1 - V.3 - V.4 - V.5 - V.7 - V.8 - V.13 - FM -

ENGENPRO - engenharia de projetos ltda.

ENGENPRO - engenharia de projetos ltda.

Rua: ...

APENAS DAS VIGAS DO PISO E COBERTURA DO TERRAÇO PAR CE, C.A. E V.13 DO MEZANINO 117 E 118.

CE-99/08

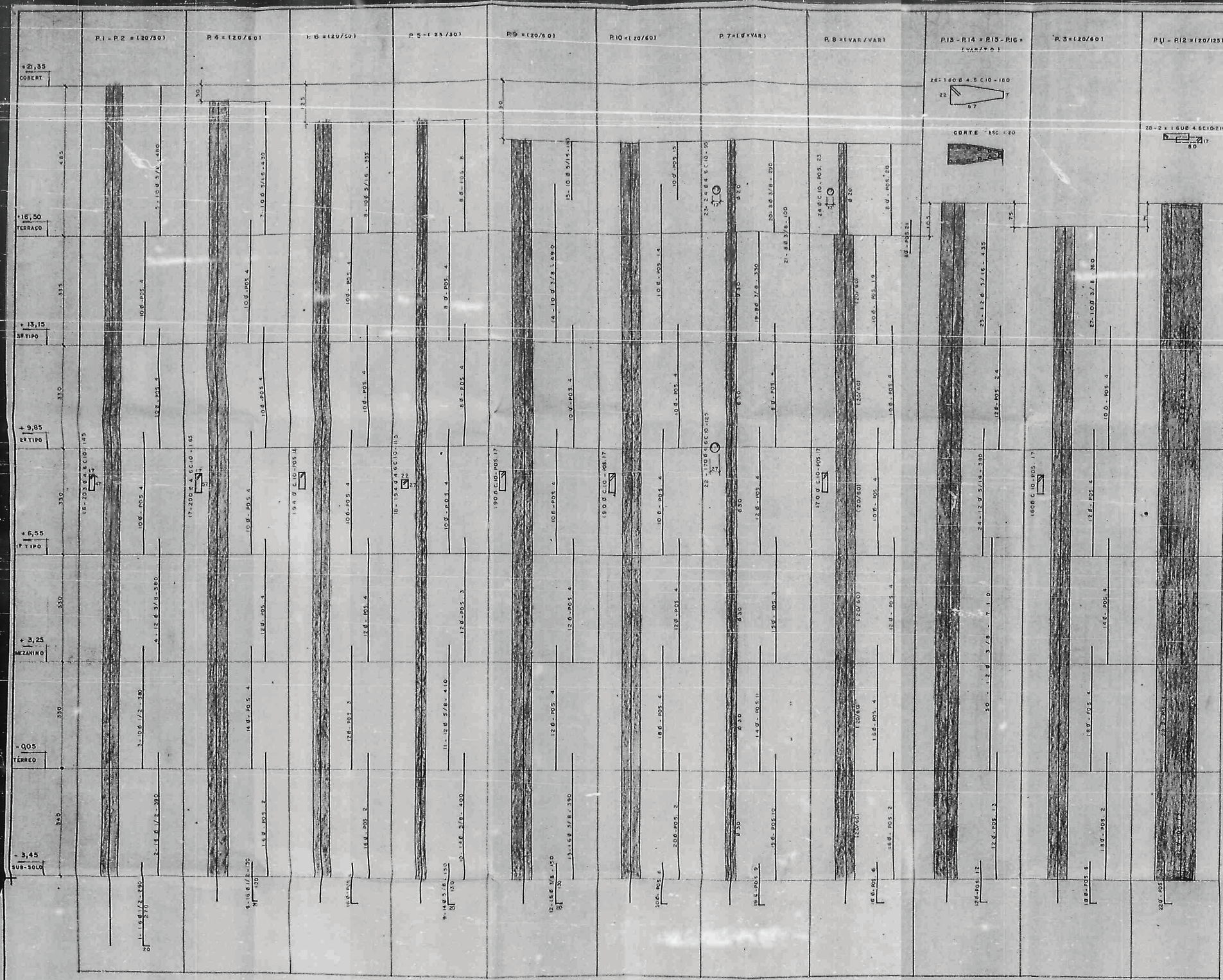

CORTE NOS PILARES
R11 - R12 = 110

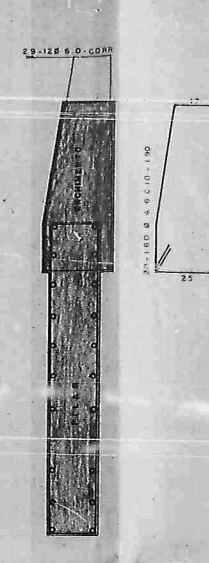

POS.	Ø	Q.	COMP.
1	1/2	32	2.90
2	"	88	3.90
3	"	32	3.80
4	3/8	524	3.80
5	"	20	4.80
6	1/2	88	4.50
7	3/8	10	4.30
8	"	18	3.50
9	3/8	33	1.50
10	"	33	4.00
11	"	26	4.10
12	3/8	101	1.50
13	"	108	3.90
14	"	20	4.90
15	3/8	20	1.85
16	4.6	600	1.45
17	"	11.04	1.65
18	"	1.94	1.15
19	3/8	18	3.30
20	"	16	2.90
21	"	16	1.00
22	4.6	1.70	1.25
23	"	24	0.95
24	3/8	1.84	3.80
25	"	4.8	4.35
26	4.6	5.40	1.50
27	3/8	10	5.60
28	4.6	6.40	2.10
29	6.0	24	1.90
30	4.6	3.20	4.00
31	"	51	3.22
32	"	51	4.28
33	"	90	1.70
34	"	27	3.00

ESCALA: LANCES (18°, 10° E 12°)
(3 x 1)

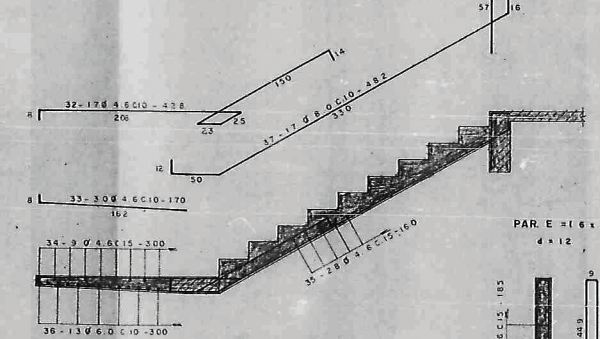

ESCALA: LANCES (7°, 9° E 11°)
(3 x 1)

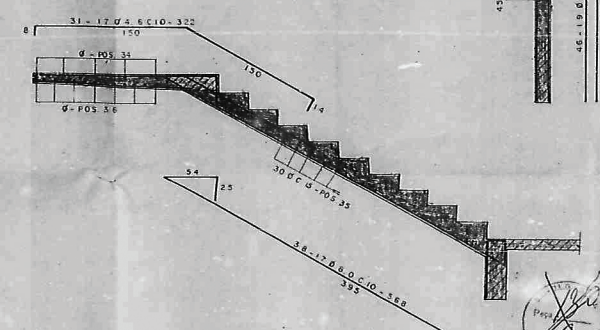

ESCALA: LANCES (4° E 6°)
(2 x 1)

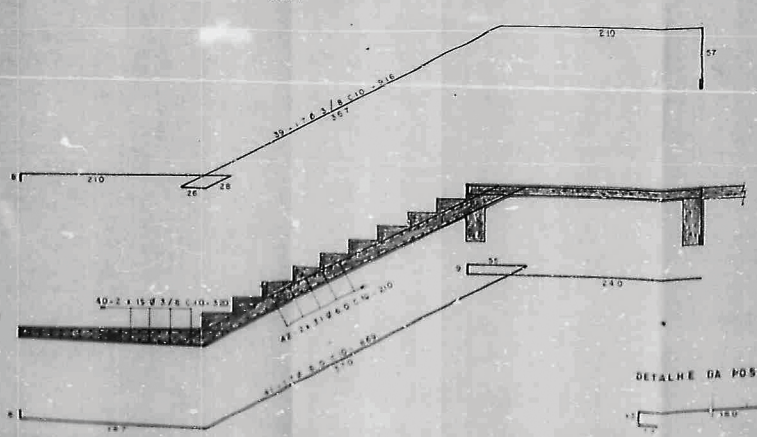

ESCALA: LANCES (3° E 5°)
(2 x 1)

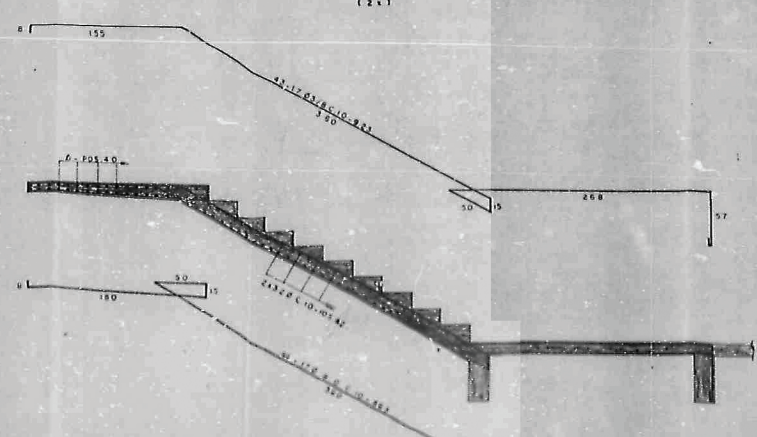

POS.	Ø	Q.	COMP.
35	4.6	1.74	1.60
36	6.0	39	3.00
37	8.0	51	4.82
38	"	51	5.68
39	3/8	34	9.16
40	"	76	3.20
41	6.0	34	8.69
42	6.0	2.52	2.10
43	3/8	34	9.3
44	8.0	34	8.63
45	4.6	1.32	1.85
46	6.0	1.14	4.49
47	4.6	12	3.00
48	3/8	21	4.00
49	4.6	57	1.35
50	3/8	48	7.10

Aço	Ø	COMP.	PÊSO
1.6	7.5	0.6	9.90
2.0	1.2	1	39.9
3.0	1.24	6.50	
3.6	1.052	4.20	
3/8	4.243	2.180	
1/2	6.79	6.80	
3/8	2.88	4.60	

PÊSO TOTAL 57.70 KV.
CONCRETO 163 x 180 KV/C/M²

ENGENHO - Engenharia de Projetos Ltda.

ENG EPRO - engenharia de projetos ltda
R. S. DE BARCELONA, 153 - BRASÍLIA - D.F.

PROJETO: SIA - TRILHO 6 - LOTE 130/FIM - BRASÍLIA - D.F.

CLIENTE: SOARES LOPES & A
ARQUITETA: LUCILEIA VITORINO
ARQUITETA: MARCEL BRANDO
PROJETO: ANIMAÇÃO PILARES - ESCA
DA LANCES 18°, 10°, 12°, 7°, 9°, 11°, 4°, 6°, 3°, 5°
DATA: 05/07/07

CE: 05/07

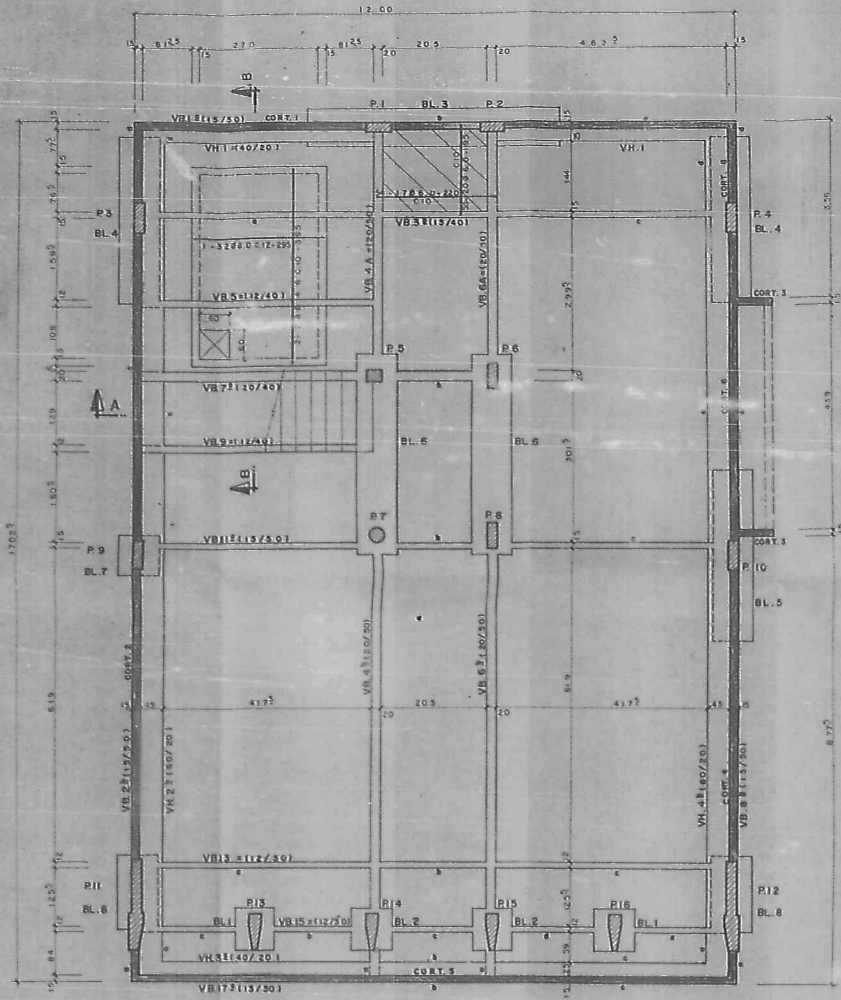

CORTE: B - B

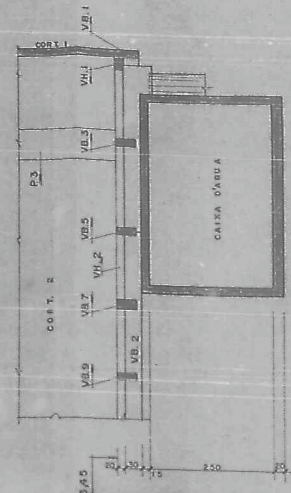

FUNDO DA CAIXA D'ÁGUA

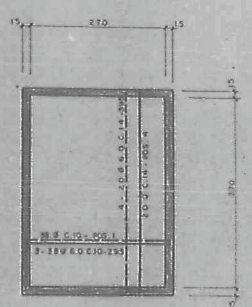

CORTE: A - A

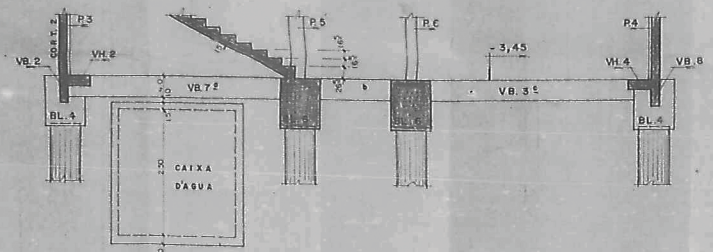

CORTE: C - C

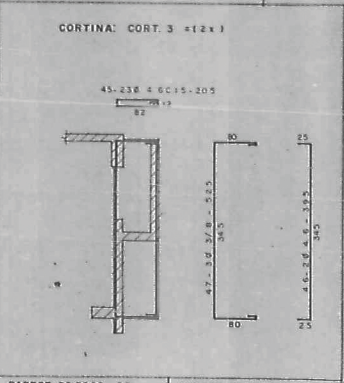
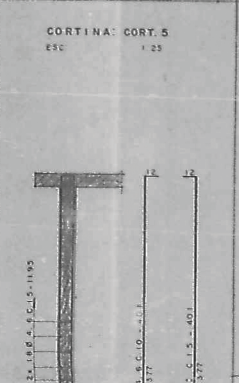
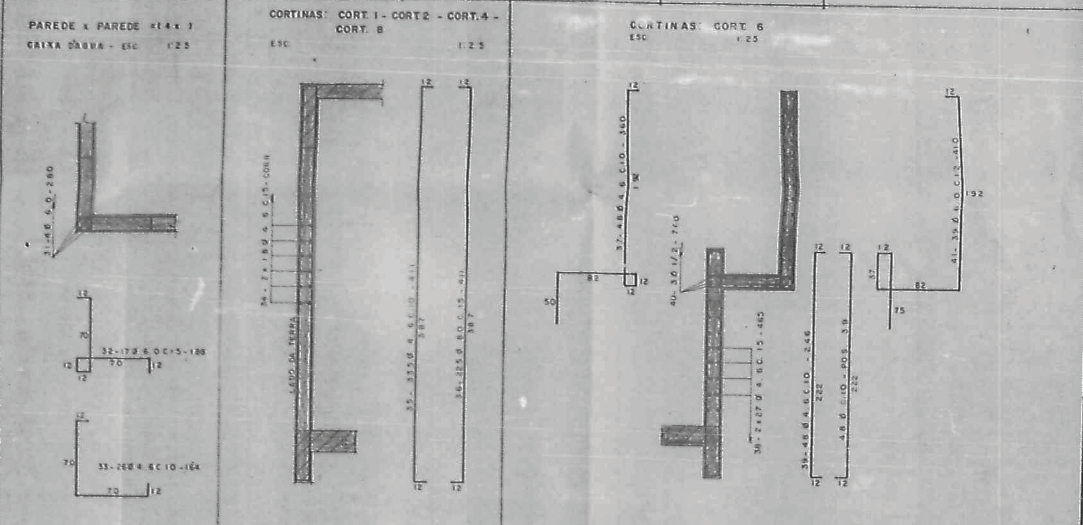
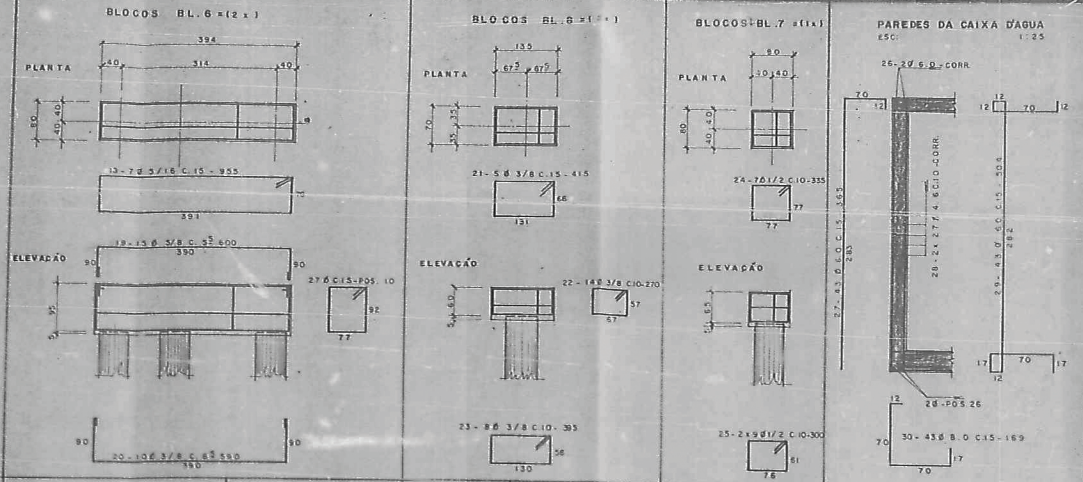
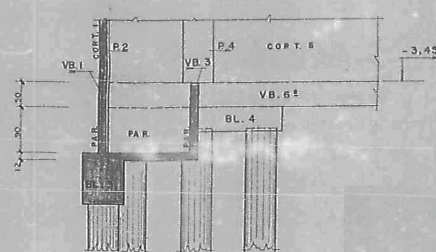

POS.	W	Q.	COMR.	POS.	W	Q.	COMR.
1	8,0	7,0	3,95	41	6,0	3,9	4,10
2	4,6	2,8	3,95	42	4,6	3,8	11,85
3	6,0	3,8	2,95	43	-	1,18	4,01
4	-	4,0	3,95	44	8,0	7,9	4,01
5	-	1,2	3,25	45	4,6	4,6	2,05
6	-	2,8	2,95	46	-	4	3,95
7	3/8	1,4	3,30	47	3/8	6	5,25
8	-	3,6	2,95	48	-	4	5,15
9	5/16	7	11,75	49	-	4	5,40
10	3/8	1,2	3,60	50	4,6	2,2	3,17
11	5/8	1,3	12,10	51	-	1,6	1,95
12	5/8	2,1	8,43	52	-	2,6	3,12
13	3/8	1,2	5,55	53	-	1,6	2,20
14	5/8	2,4	5,45	54	6,0	1,7	2,20
15	5/16	5	3,35	55	-	2,0	1,95
16	-	3,5	3,60				
17	1/2	1,1	5,40				
18	5/16	1,4	9,55				
19	5/8	2,0	6,00				
20	3/8	2,0	5,90				
21	-	1,0	4,15				
22	-	2,8	2,70				
23	-	1,6	3,95				
24	1/2	7	3,35				
25	-	1,8	3,00				
26	6,0	4	CORR.				
27	-	4,3	3,63				
28	4,6	5,4	CORR.				
29	8,0	4,3	5,04				
30	8,0	4,3	1,69				
31	6,0	1,6	2,80				
32	-	6,8	1,98				
33	4,6	1,04	1,64				
34	-	3,0	CORR.				
35	-	3,35	4,11				
36	8,0	2,25	4,11				
37	4,6	4,8	3,60				
38	-	5,4	4,65				
39	-	9,6	2,46				
40	1/2	3	7,40				

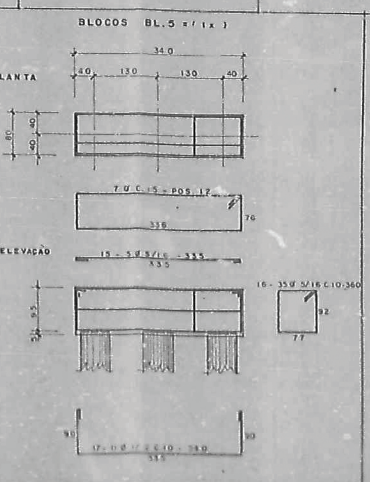
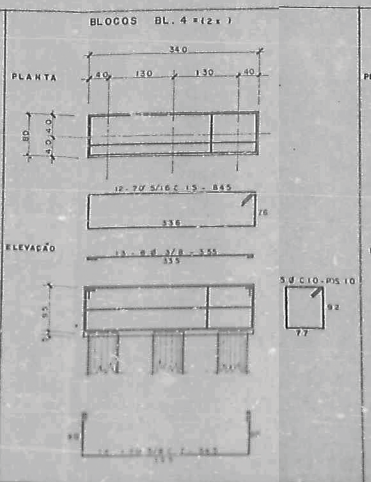
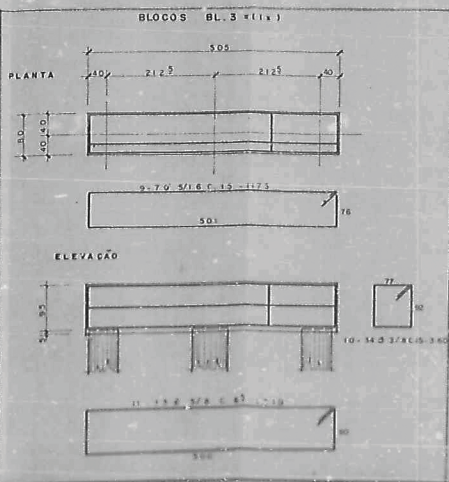
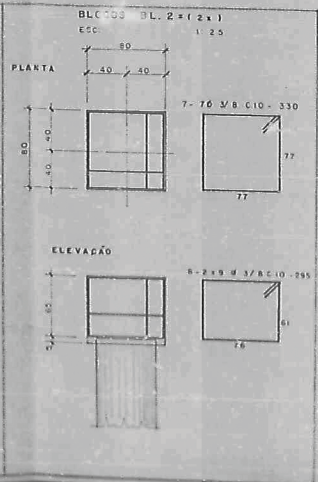
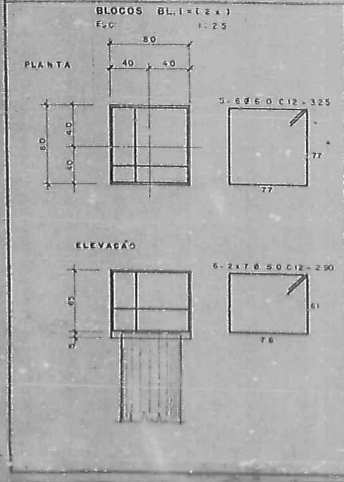
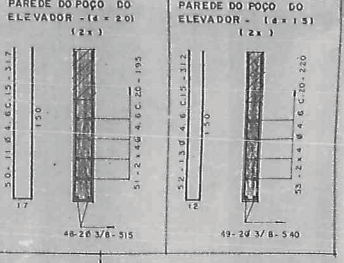

ÁGUA	B	COMR.	PÉSO
8,8	57,22	7,60	
9,0	1,920	4,20	
9,0	1,521	5,95	
5/16	5,36	2,15	
3/8	1,010	5,80	
1/2	1,59	1,60	
5/8	4,63	7,30	
PESO TOTAL 346,0 KG			
CONCRETO fca = 150 Kg/cm²			

NOTAS:
 1) A TAXA DO TERRENO PARA EXECUÇÃO DA CAIXA D'ÁGUA DEVERÁ SER IGUAL OU SUPERIOR 573 gr/cm².
 2) VIDE DETALHES DAS VIGAS BALDRAMES NO DESENHO C.E. 95/08.
 ENGENHO - engenharia de projetos

ENGENPRO engenharia de projetos Ltda
 Rua A. ...
 BRASÍLIA D.F.

ÁREA	SIA - TRECHO 50 - LOTE 130/140 - BRASÍLIA D.F.
CLIENTE	SOARES LEONE S.A.
PROJETO	FORÇA E DETALHES DO PISO DO SUB-SOLO - BLOCOS E CORTINAS
ARQUITETO	MARCEL BRANCO
CONSTRUTORA	
PROJ. EXEC.	
PROJ. EXEC.	

C.E. 95/08

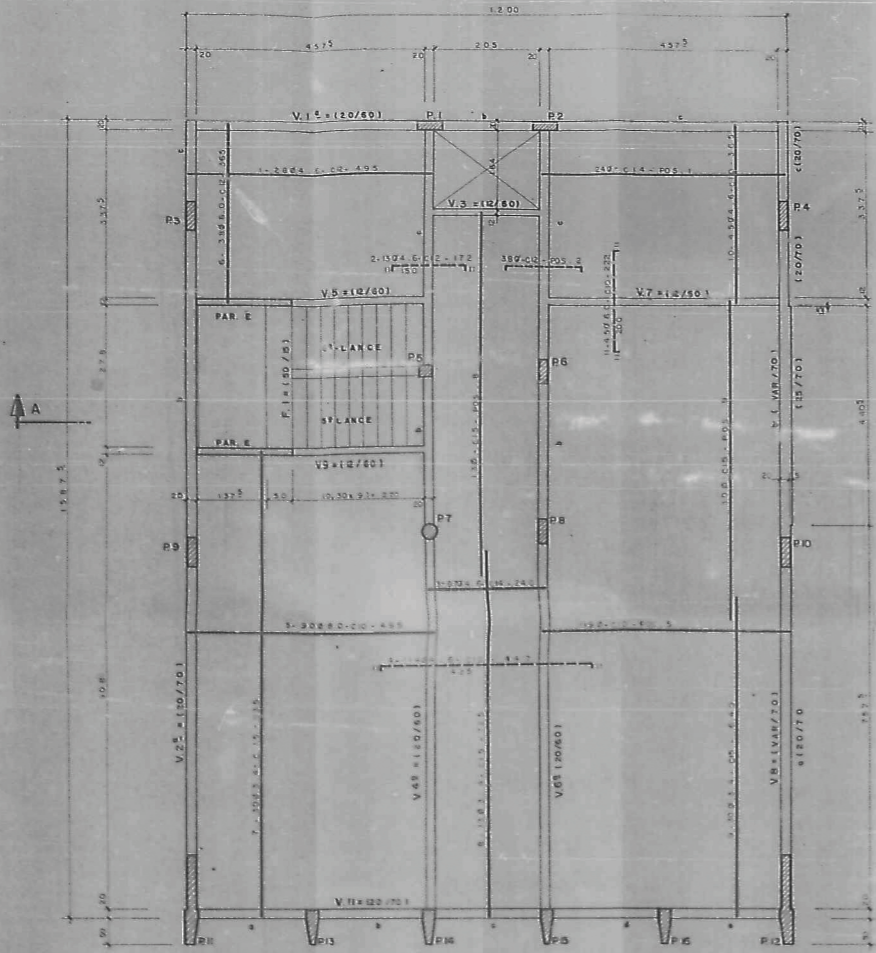

FORMA DO PISO DO TÉRREO

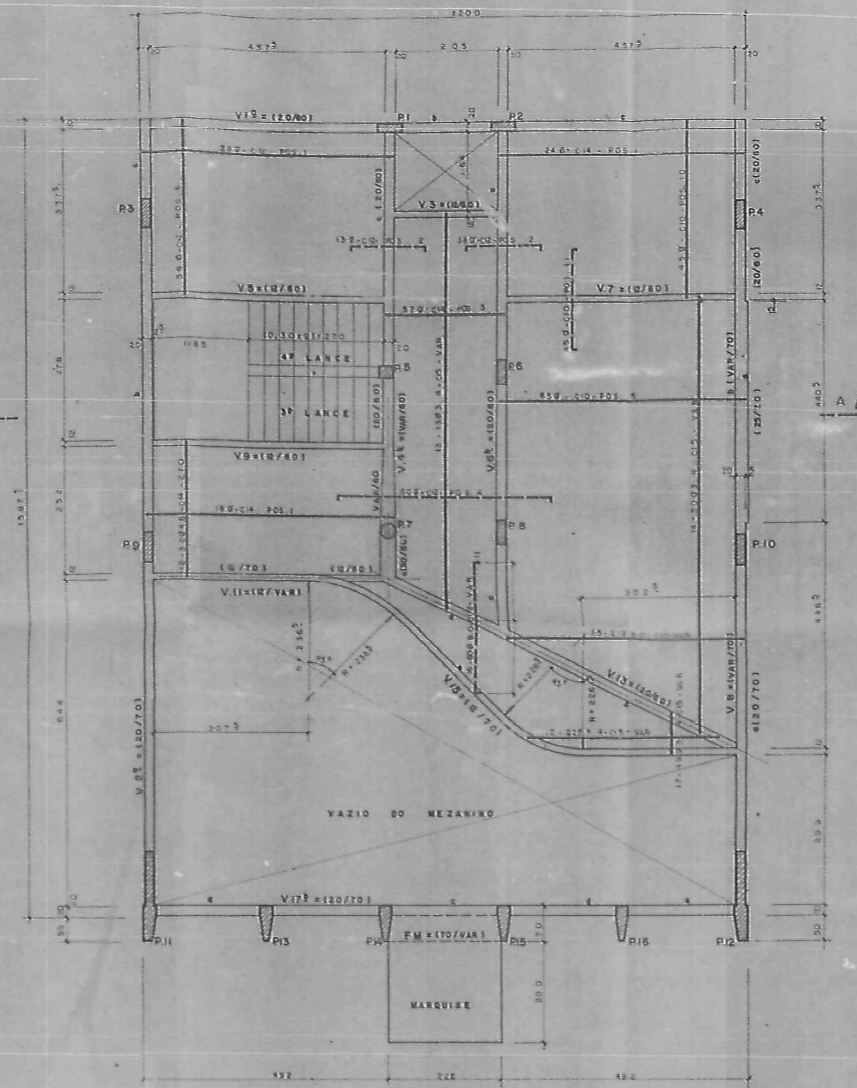

CORTE A-A

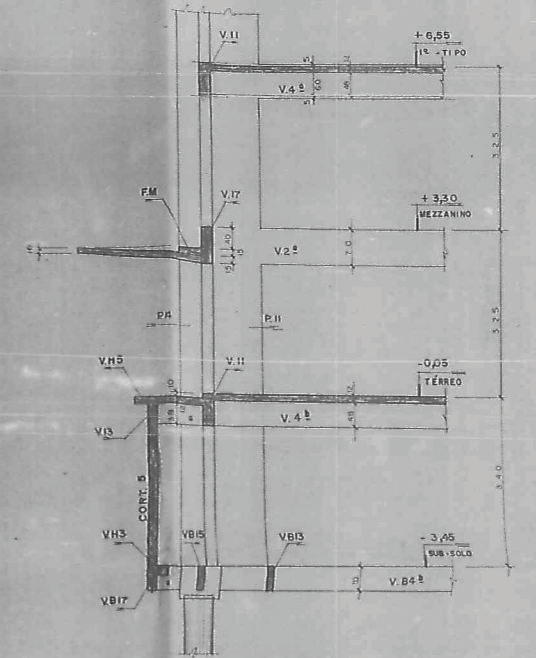

ARMAÇÃO DA MARQUISE

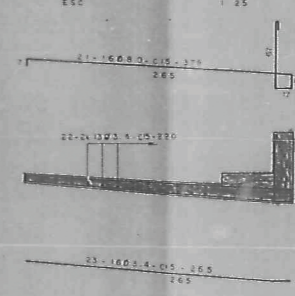

POS	Ø	Q.	COMP.
1	4.6	28.8	4.95
2	"	25.5	1.72
3	"	4.62	2.40
4	"	4.92	4.47
5	8.0	92.8	4.95
6	6.0	22.7	3.65
7	3.4	1.60	3.35
8	"	10.4	7.25
9	"	24.0	6.40
10	4.2	1.80	2.25
11	6.0	23.7	2.22
12	4.6	3.2	2.70
13	3.4	1.3	VAR
14	"	3.0	VAR
15	8.0	21	VAR
16	"	6.0	VAR
17	3.4	4.9	VAR
18	"	2.2	VAR
19	"	6	0.40
20	"	1.4	1.30
21	8.0	1.6	37.8
22	3.4	2.6	2.20
23	"	1.6	2.65

DETALHE GERAL DA ESCADA

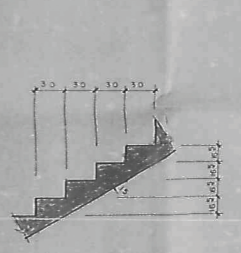

ASO	Ø	COMP.	PESO
0	3.3	1.0	0.0
1	4.6	1.0	4.0
2	6.0	1.35	31.0
3	8.0	4.6	19.00
PESO TOTAL			3.250 Kg
CONCRETO FCK=180 Kg/cm ²			

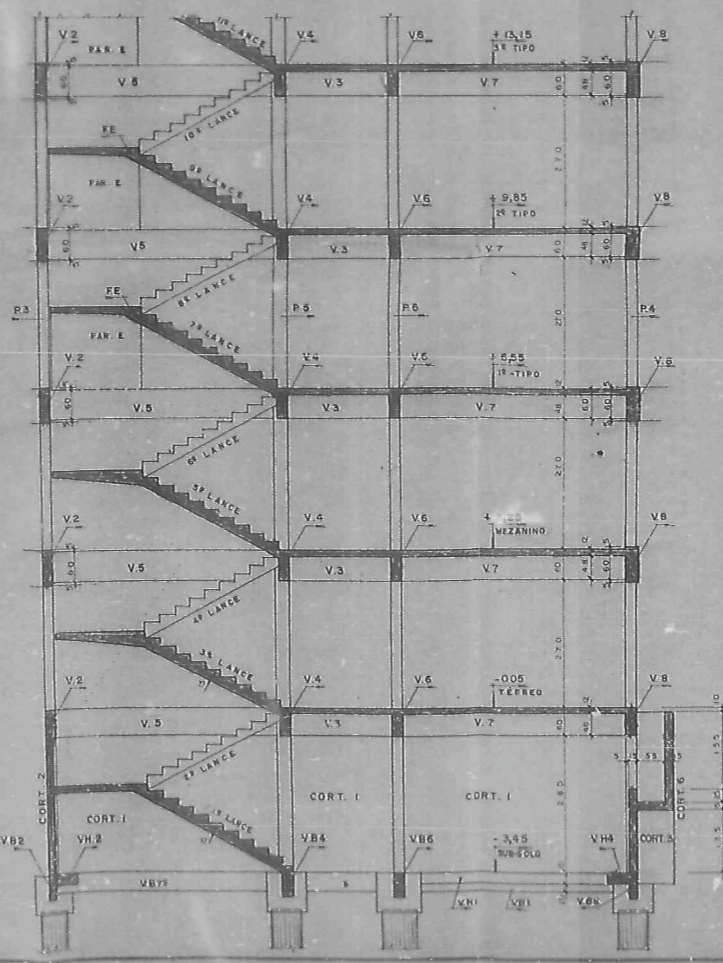
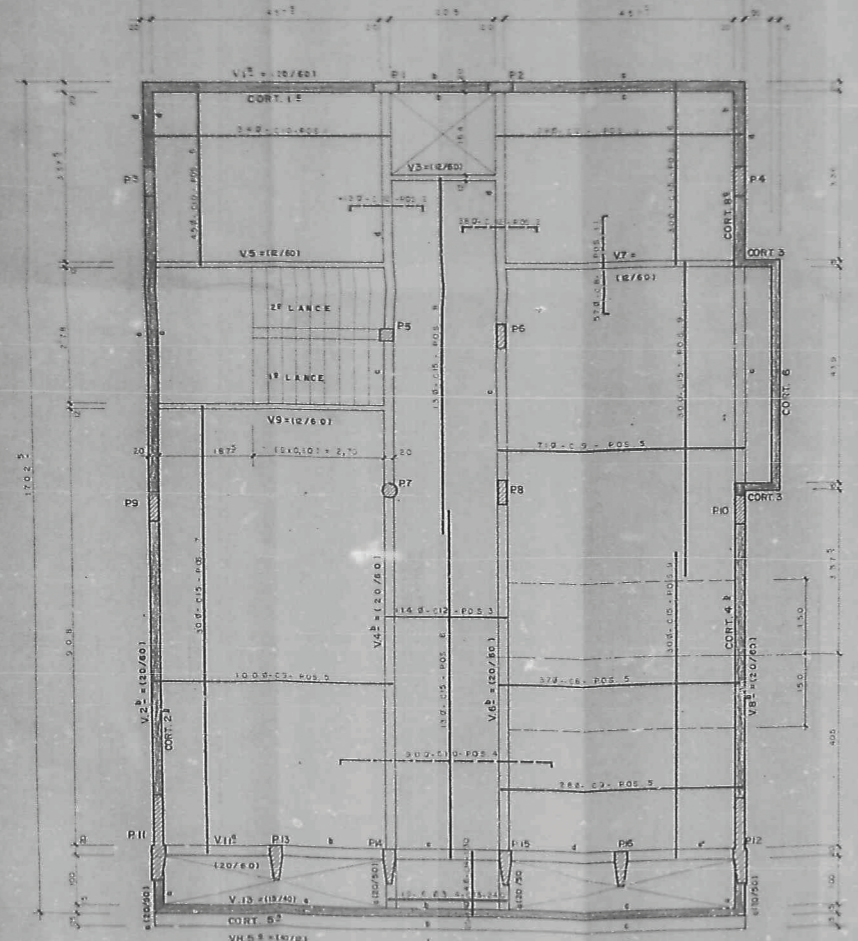

ENGEPRO Engenharia de Projetos Ltda

CLIENTE: SIA - TRECHO 6 - LOTES 130-140 - BRASILIA D.F.

ARQUITETA: MARCEL BRANCO

PROJETO: FORMA E DETALHES DOS PISOS: TÉRREO - MEZANINO E TIPO 418

CE-95/03

